

The logo for SYNINA Residency features a stylized yellow and orange graphic on the left, resembling a modern architectural element or a flame. To its right, the word "SYNINA" is written in a bold, teal, sans-serif font, and "Residency" is written below it in a white, elegant script font.

**SYNINA**  
*Residency*



*Inspired Living*



Life Just Got Better  
at Synina Residency

IO/IO  
★★★★★



Encircled in a haven of scenic views, Synina Residence is conveniently situated in the highly sought after, private and secure neighborhood of Kileleshwa, Nairobi. This development comprises 77 opulent residences thoughtfully constructed with separate domestic living quarters.

**77**

**MODERN & SPACIOUS RESIDENCES + DSQ**

**A LUXURIOUS MIX OF 3, 4, & 5 BEDROOM  
EXECUTIVE APARTMENTS**

**2 PARKING BAYS PER UNIT  
AND VISITOR PARKING AVAILABLE**

## Come On Inside! Sit Back, Relax. Your New View Awaits.

Designed with meticulous attention to the needs of the occupier, Synina Residency spares no expense on the sizes of the rooms. Households today have evolving spatial needs to cater for their growing families and this development's key merit is the ample sizes of the rooms in each unit.

The spacious living area boasts soaring ceilings with full-height windows bathing the house with natural light and breathtaking views. The dining area and sitting room opens out to a large terrace with spectacular views of Nairobi's Cityscape. The closed kitchen is both stylish and functional.

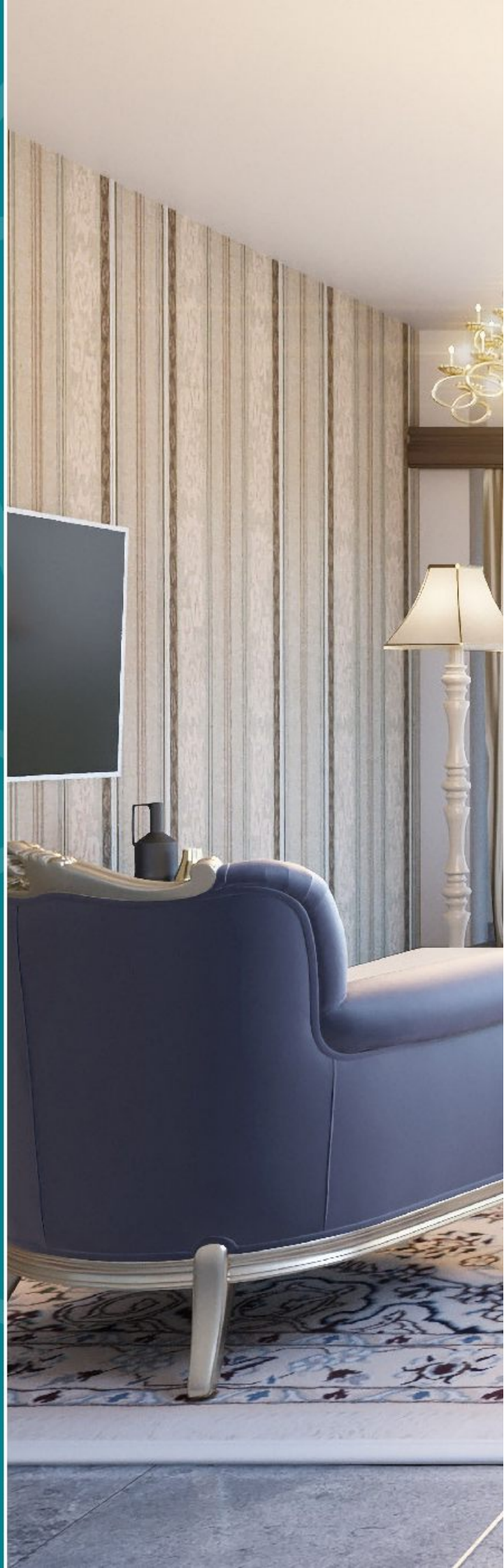







If your apartment was your best friend,  
this is what it would look like.

The Bedrooms and Bathroom spaces provide a tranquil retreat offering a sense of relaxation and privacy, embracing an amazing view of the city. Enjoy the chic, urban living that awaits you at Synina Residency, where relaxation & sophistication merge to create the ideal place to call home!









## Features & Amenities

- Spacious Lounge and Dining Area
- Fully Fitted Modern Kitchen with Pantry
- High Speed Elevators
- 2 Parking Spaces Per Unit
- Borehole & Back Up Generator
- CCTV Surveillance & 24-hour Security
- Kids Play Zone
- Fully-equipped Gym
- Dedicated Fitness Center for Ladies
- Infinity Swimming Pool
- Spacious Rooftop Entertainment Lounge
- Serene Garden



## UNIT TYPES

UNIT TYPE	PLINTH AREA	PRICE
3 Bedroom + DSQ	2400 Sq. Feet / 223 Sq. Metres	<b>\$210,000</b>
4 Bedroom + DSQ	3200 Sq. Feet / 298 Sq. Metres	<b>\$270,000</b>
5 Bedroom + DSQ	3500 Sq. Feet / 325 Sq. Metres	<b>\$290,000</b>

## PAYMENT PLAN

PARTICULARS	DEPOSIT + INSTALMENTS
Initial Deposit	30%
Next 6 Months	30%
Next 6 Months	30%
Last 6 Months	10%



2400 Sq. Feet / 223 Sq. Metres

**\$210,000**

## 3 Bedroom + DSQ

### KEY

- |                     |                    |
|---------------------|--------------------|
| 1. Entry Lobby      | 11. Master Bedroom |
| 2. Cloakroom        | 12. Master Closet  |
| 3. Dining           | 13. Corridor       |
| 4. Lounge           | 14. Bedroom 2      |
| 5. Balcony          | 15. Bathroom 2     |
| 6. Bedroom 1        | 16. Kitchen        |
| 7. Bathroom 1       | 17. Store          |
| 8. Bedroom 1 Closet | 18. Kitchen Yard   |
| 9. Master Bathroom  | 19. Staff Bathroom |
| 10. Master Balcony  | 20. Staff Quarters |

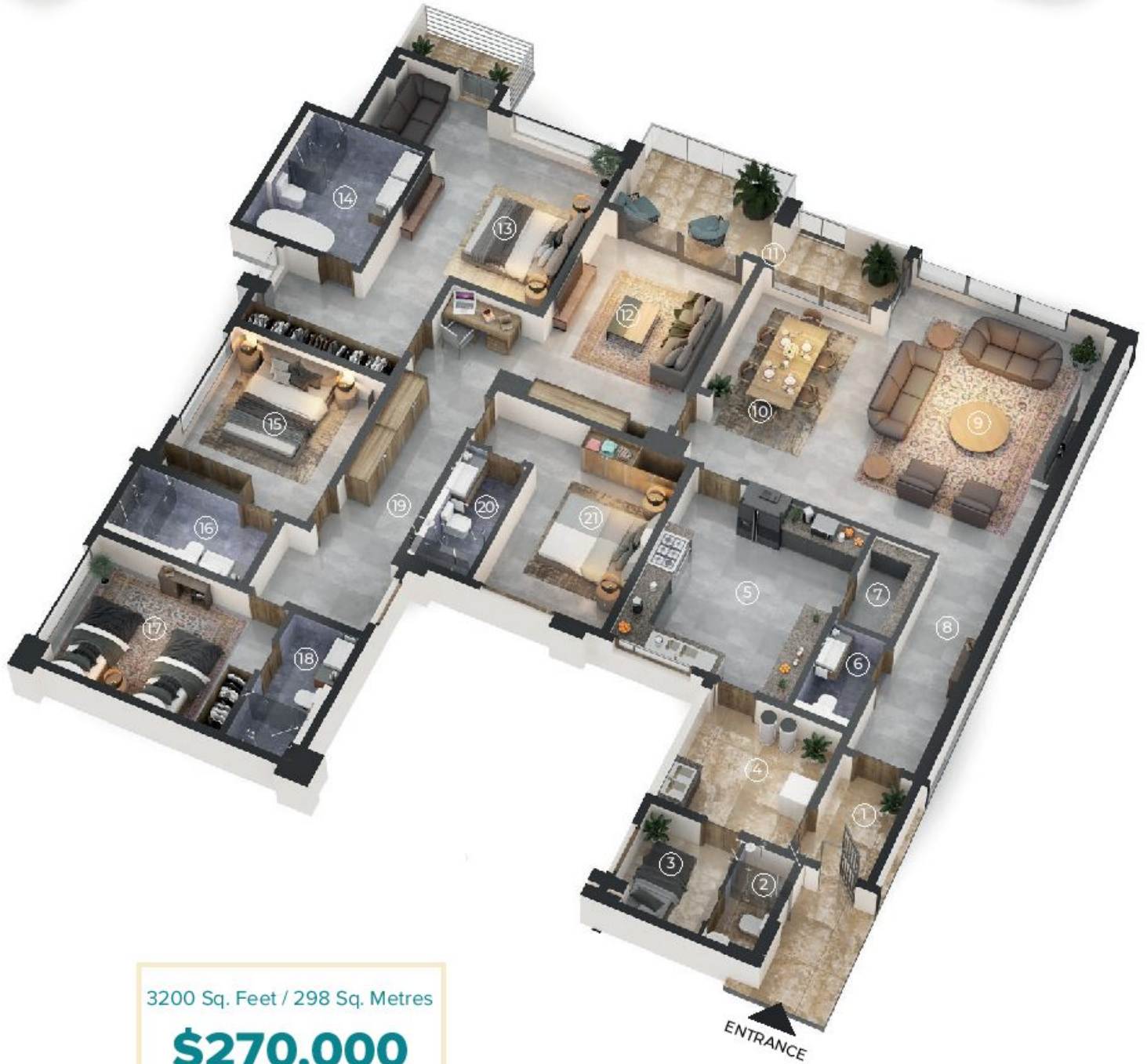

3200 Sq. Feet / 298 Sq. Metres

**\$270,000**

## 4 Bedroom + DSQ

### KEY

- |                   |                     |
|-------------------|---------------------|
| 1. Entry Lobby    | 11. Balcony         |
| 2. Staff Bathroom | 12. Family Room     |
| 3. Staff Quarters | 13. Master Bedroom  |
| 4. Kitchen Yard   | 14. Master Bathroom |
| 5. Kitchen        | 15. Bedroom 2       |
| 6. Guest Bathroom | 16. Bathroom 2      |
| 7. Store          | 17. Bedroom 3       |
| 8. Lobby          | 18. Bathroom 3      |
| 9. Lounge         | 19. Corridor        |
| 10. Dining        | 20. Bathroom 1      |
|                   | 21. Bathroom 2      |



3500 Sq. Feet / 325 Sq. Metres

**\$290,000**

## 5 Bedroom + DSQ

### KEY

- |                   |                     |
|-------------------|---------------------|
| 1. Entry Lobby    | 13. Family Room     |
| 2. Staff Bathroom | 14. Master Bedroom  |
| 3. Staff Quarters | 15. Master Balcony  |
| 4. Kitchen Yard   | 16. Master Bathroom |
| 5. Guest Bathroom | 17. Bathroom 1      |
| 6. Lobby          | 18. Bedroom 1       |
| 7. Store          | 19. Bedroom 2       |
| 8. Kitchen        | 20. Bathroom 2      |
| 9. Corridor       | 21. Balcony         |
| 10. Lounge        | 22. Bathroom 3      |
| 11. Dining        | 23. Bedroom 3       |
| 12. Balcony       | 24. Bathroom 4      |
|                   | 25. Bedroom 4       |



# Penthouses

## *Luxury Redefined*

Sitting on the topmost two floors, Synina Residency's penthouses boast massive windows with sweeping views of the scenic Nairobi skyline. There are 5 Bedroom penthouse units of simplex and duplex typologies with spacious, stylish and functional living, bedrooms, dining and kitchen areas.

### UNIT TYPES

PENT HOUSES	PLINTH AREA	PRICE
5 Bedroom + DSQ Simplex Penthouse	4,700 Sq. Feet / 437 Sq. Metres	<b>\$450,000</b>
5 Bedroom + Study + DSQ Duplex	6,500 Sq. Feet / 604 Sq. Metres	<b>\$590,000</b>

# 5 Bedroom

## Study + DSQ Duplex Penthouse



6,500 Sq. Feet / 604 Sq. Metres

**\$590,000**

### Lower Level

#### KEY

- |                            |                             |
|----------------------------|-----------------------------|
| 1. Entry Lobby             | 9. Family Room              |
| 2. Kitchen Yard            | 10. Family & Master Balcony |
| 3. Kitchen                 | 11. Guest Bathroom          |
| 4. Pantry                  | 12. Bedroom 1               |
| 5. Lobby                   | 13. Bathroom 1              |
| 6. Lounge                  | 14. Store                   |
| 7. Dining                  | 15. Lift & Staircase Lobby  |
| 8. Lounge & Dining Balcony |                             |



# 5 Bedroom

## Study + DSQ Duplex Penthouse



### Upper Level

#### KEY

- 16. Lift & Staircase Lobby
- 17. Home Office
- 18. Staff Bathroom
- 19. Staff Quarters
- 20. Staff Quarters Entrance (Accessed Externally)
- 21. Master Bathroom
- 22. Walk-in Closet
- 23. Master Bedroom
- 24. Balcony
- 25. Bedroom 2
- 26. Bathroom 2
- 27. Bedroom 3
- 28. Bathroom 3
- 29. Balcony
- 30. Bedroom 4
- 31. Bathroom 4
- 32. Store



4,700 Sq. Feet / 437 Sq. Metres

**\$450,000**

## 5 Bedroom + DSQ Simplex Penthouse

### KEY

- |                         |                       |
|-------------------------|-----------------------|
| 1. Entry Lobby          | 14. Bedroom 2         |
| 2. Staff Bathroom       | 15. Bathroom 2        |
| 3. Staff Quarters       | 16. Bathroom 3        |
| 4. Kitchen Yard         | 17. Bedroom 3         |
| 5. Kitchen              | 18. Master Bedroom    |
| 6. Pantry               | 19. Walk-in Closet    |
| 7. Lobby                | 20. Master Bathroom   |
| 8. Lounge               | 21. Bathroom 4        |
| 9. Dining               | 22. Bedroom 4         |
| 10. Living Room Balcony | 23. Corridor          |
| 11. Bedroom 1           | 24. Family Room       |
| 12. Bathroom 1          | 25. Panoramic Balcony |
| 13. Guest Bathroom      |                       |



Mander Rd

Auto body Shop

  
KENYA HIGH SCHOOL

Finnlemm Sacco Limited

Gatundu Rd

Evergreen Apartments

Emilia Apartments

  
SYNINA

Tinderet Avenue

BLN House

Tinderet Avenue

  
KENTON COLLEGE  
PREPARATORY SCHOOL

Gatundu Rd

Vanilla Park

Expo Villas

Pine Breeze Apartments



+254 716 777 555

2nd Floor, Gateway Place, Milimani Road.  
PO. Box 47346 Nairobi - 00100 - Kenya.  
[www.synina.co.ke](http://www.synina.co.ke)